

# ABN AMRO KONINGSKADE

Architect  
Client  
Location  
Year

TENW ARCHITECTEN  
DE KOK BOUWGROEP  
NETHERLANDS, THE HAGUE  
2017

07499

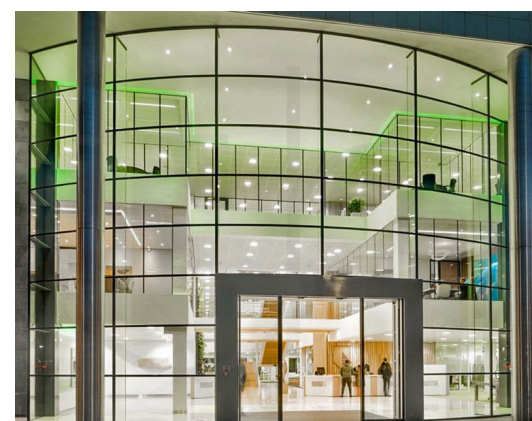
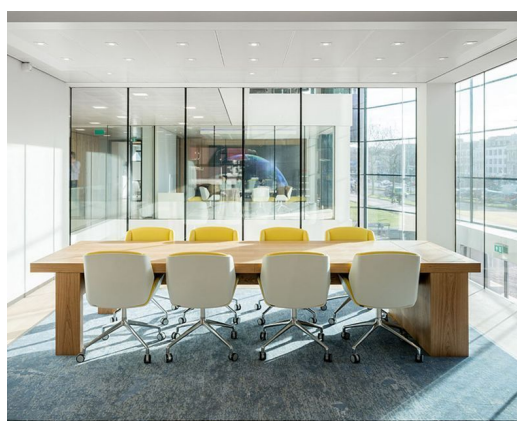
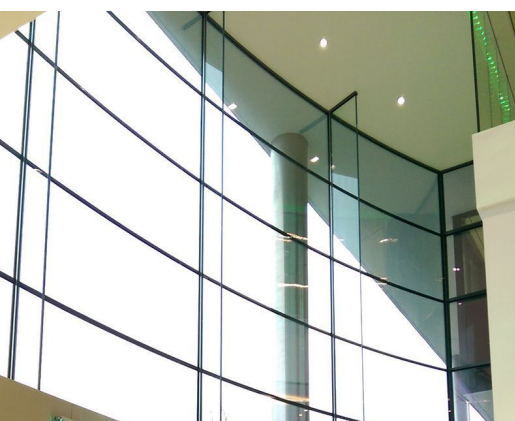

ABN Amro's new regional head office is featured by a fully glazed and bent entrance façade. The entrance is situated at the Koningskade, directly visible for everybody entering the city of The Hague by car. They notice the façade has a green hue, which has been processed in the glass upon special request from the client.

The new glass entrance makes the building easy to recognize, while the bent glass increases the sense of accessibility. The project is designed by TenW architecten, who enhanced the sustainability of the former Chamber of Commerce building significantly.

**octatube**